



PACKLEADER FARM

Presents:

**AHBA Sanctioned:
Ranch Large Flock (RLF)
Instinct Test (HCT)
Junior Herd Dog (JHD)**

March 31 & April 1, 2012

Location: PackLeader Farm, Gig Harbor, WA

Judges:

Ron Fischer

Barbara Davenport

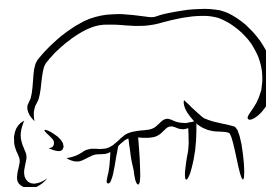

**Day of Entries taken at 8:00 AM (if there are still openings)
Handler's Meeting/Trial starts 8:30 AM**

Location and Directions

4401 Crews Road KPN, Gig Harbor, WA 98329 Home: 253-884-5959 Cell: 253-732-5959

Use directions below - MapQuest will get you close, then get you lost.

- Hwy 16, Exit for Purdy/Key Center//Shelton, Hwy 302 W.
- Travel into Purdy, Turn left at the signal following sign for Hwy 302W (Shelton/Key Center)
- Cross Wauna Bridge, travel 5.1 miles
- Turn **RIGHT** onto Hwy 302 W, Elgin Clifton Rd KPN, toward Shelton/Allyn (There are clearly marked signs leading to Hwy 302 W)
- Travel 1.2 miles, turn **RIGHT** onto 150th
- Travel .1 miles (end of chain link fence) turn **LEFT** onto 1st road into Rocky Creek Conservation Area
- Follow road approximately .8 mile through park, to PackLeader's green farm gate, follow road past two-story house (white w/green trim) to parking lot at the top of the driveway.

[Click here for directions from the PackLeader website.](#)

➤ **Motels & Camping**

****Westwynd Motel 6703 144th St. NW., Gig Harbor, 98332 (800) 468-9963**

****incredibly dog-friendly and very accommodating**

Best Western Wesley Inn 6575 Kimball Drive, Gig Harbor, 98335 (888) 462-0002

The INN at Gig Harbor 3211 56th St. N.W., Gig Harbor. 98335 (800) 795-9980

Gig Harbor RV Resort 9515 Burnham Drive NW, Gig Harbor, 98332 (800) 526-8311

PackLeader Farm Camping and/or RVs may park on site, no hookups

➤ **Food – Karen's Kitchen – Saturday and Sunday**

Lunch is available on the site for \$7.00 per person.

➤ **Information and Entry Forms: Barbara 253-732-5959 K9SayNo@aol.com**

➤ **Entries**

Pre-entries must arrive no later than March 23rd, 2012.

Make money orders or checks payable to PackLeader Farm.

Mail to: Barbara Davenport, 14401 Crews Road KPN, Gig Harbor, WA 98329

➤ **Entry Fees**

RLF Sheep Pre-Entry: \$35.00 Day of: \$40.00

JHD Sheep Pre-Entry: \$30.00 Day of: \$35.00

HCT Sheep Pre-Entry: \$25.00 Day of: \$25.00

Day of Entries (if runs are still available) accepted prior to the start of class beginning at 8AM.

➤ **Judges**

<u>Date</u>	<u>RLF</u>	<u>JHD and HCT</u>
March 31	Barbara Davenport	Ron Fischer
April 1	Ron Fischer	Barbara Davenport

➤ **Limits RLF 25 runs JHD & HCT (Combined) 25 runs**

➤ **Awards**

Rosettes 1st – 4th place Each Day
Reserve High in Trial & High in Trial Each Day
High Combined for the weekend

Please fill out one entry form, per dog

Entry Number: _____

Breed: _____ Reg. #: _____ Registry: _____

Reg. Name: _____

Call Name: _____ Sex: _____ DOB: _____

Sire: _____

Dam: _____

Breeder: _____

Owner: _____

Address: _____

City: _____ State: _____ Zip: _____

Phone: _____ E-mail: _____

Name of handler if other than owner: _____

Check Class(es) you are entering

Class	Sat	Sun	Before/on 3/23/2012	After 3/23/2012	Totals
RLFI			\$35.00	\$40.00	
RLFII			\$35.00	\$40.00	
RLFIII			\$35.00	\$40.00	
JHD			\$30.00	\$35.00	
HCT			\$25.00	\$25.00	
Lunch			\$7.00	\$7.00	
Grand Total					

In consideration for participation in this event, I agree to assume all responsibility for any claim, loss or damage, of whatever kind or nature, whether to person or property, which may be caused at or near this event, either directly or indirectly, by me or the dog(s) I have entered in or brought to this event. I further agree that I will hold AHBA, PackLeader Farm, Barbara Davenport and/or Steve Weigley harmless and defend them from any and all liability for any injury, claimed damage or loss, of whatever kind or nature, whether to person or property, caused at or near this event whether directly or indirectly, by or to me or any dog(s) I have entered in or brought to this event. I agree to indemnify AHBA, PackLeader Farm, Barbara Davenport and/or Steve Weigley for any loss, cost or expense including attorney fee and cost to which AHBA, PackLeader Farm, Barbara Davenport and/or Steve Weigley might be subject to as a result of any claim, suit, loss or damage caused in any way by any act or negligence on my part or on the part of any dog(s) I have entered in or brought to the event. I acknowledge that while the AHBA may provide sanctioning for this event with regard to the issuing of titles, it does not have and does not exercise control over the conduct of the event or those present. I certify and represent that the dog(s) I have entered in or brought to this event is (are) not a hazard to other dogs, other animals, or to people.

Signature of owner / agent

Date

GENERAL RULES:

- Time 15 minutes.
- In all elements, quiet efficient stock work is essential.
- All elements must be accomplished prior to moving on.
- All gates may be open/closed at the Handler's discretion (unless specified); however, time will not end until all gates have been restored to their original/starting position.
- Ties are broken based on individual scores in the following order: Exercise 7 "Sort and Pen", Exercise 5 "Footbath", Time.

STARTING SET- UP:

All gates are closed, except Pens #2 & #3 to Narrow Alley, which are open.
25 sheep in Arena B, 25 sheep in Trailer, 25 sheep in 3 groups located in Alley C/D, 25+ sheep in reserve.

1. **GATHER - 15 pts.:** Enter Arena B and move to the position appropriate for the team's level. Gather sheep and fetch the sheep to the Handler, and return to Handler's Post. Turn sheep clockwise around the Handler's Post and proceed to Pen #3. Exercise ends when the sheep reach Pen #3.

RLF I Dog at 75 feet from sheep, Handler within 15 feet of sheep.

RLF II Dog at 150 feet from sheep, Handler ½ way.

RLF III Handler and dog 150 feet from sheep

2. **RLF III ONLY: Obstacle #1 - 10 pts.:** After gather, handler remains at the Handler's Post, while the dog drives the sheep toward Obstacle #1, turn the sheep right passing thru the obstacle. Sheep are then turned left and taken to Pen #3. Handler may leave the Handler's Post when the sheep pass the plane of the obstacle. Exercise ends when the sheep reach Pen #3.

3. **NARROW ALLEY - 10 pts.:** All levels: Dog will hold the stock off Pen #3 gate, allowing the handler to freely open the gate. Move stock through Pen #3, down Narrow Alley, through Pen #2 and into Arena A. Exercise ends when Arena A gate is closed.

4. **FETCH/DRIVE - 20 pts.:** All levels: Proceed to the Handler's Post. From the Handler's Post fetch/drive sheep through free standing Obstacle #2 and back to the Handler's Post. Dog will hold the stock near the Handler's Post while the handler proceeds to the gate for Pen #2. Handler recalls the dog and team exits Arena A thru Pen #2. Exercise ends when Pen #2 gate is closed.

RLF I Handler may take any position.

RLF II Handler must remain behind the Handler's Line while the stock are taken thru Obstacle #2.

RLF III Handler must remain at the Handler's Post until the stock return to the Handler's Post.

5. **FOOTBATH - 10 pts.:** All levels: Proceed to Trailer. Remove sheep from Trailer, move sheep through Footbath and release in Arena B. Exercise ends when Arena B gate is closed.

6. **PENS/TRAILER - 15 pts.:** All levels: Take sheep from pens in Alley C/D, combine sheep and move them through Pen #2 into the Upper Back Alley, thru Pen #3 and load into Trailer (bypass the Footbath). Exercise ends when the Trailer gate is closed.

RLF I & II Handlers may take any position.

RLF III Handler must remain in the Narrow Alley until the stock reach Pen #3.

7. **SORT AND PEN - 20 pts.:** All levels: Return to Arena A, gather sheep, move thru Pen #2 and sort sheep into 3 groups of 10, 10 & 5 sheep. Pen in separate pens in Alley C/D. Sort may be done anywhere between Arena A and pens in Alley C/D. Exercise ends when sheep are penned.

Time stops when **ALL** gates have been restored to their original/starting position.



AHBA RANCH LARGE FLOCK (RLF) TRIAL
 March 31 – April 1, 2012

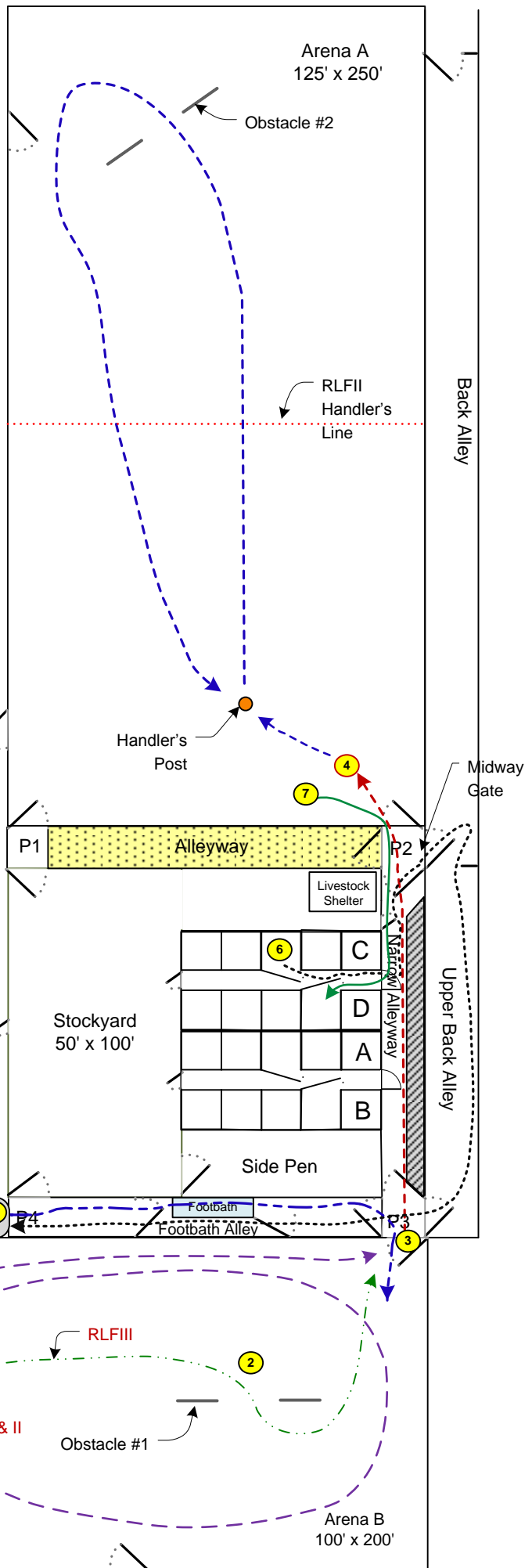
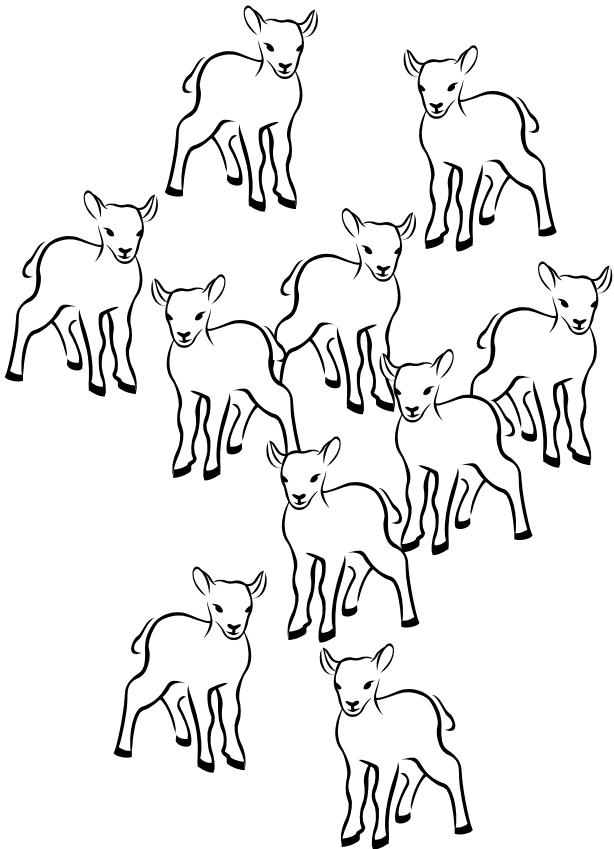

Pen alleyways are 6' wide, all other alleyways are a minimum of 12'.

All stockyard pens are 12' x 12' sq.
 Side Pens are 18' x 60'